

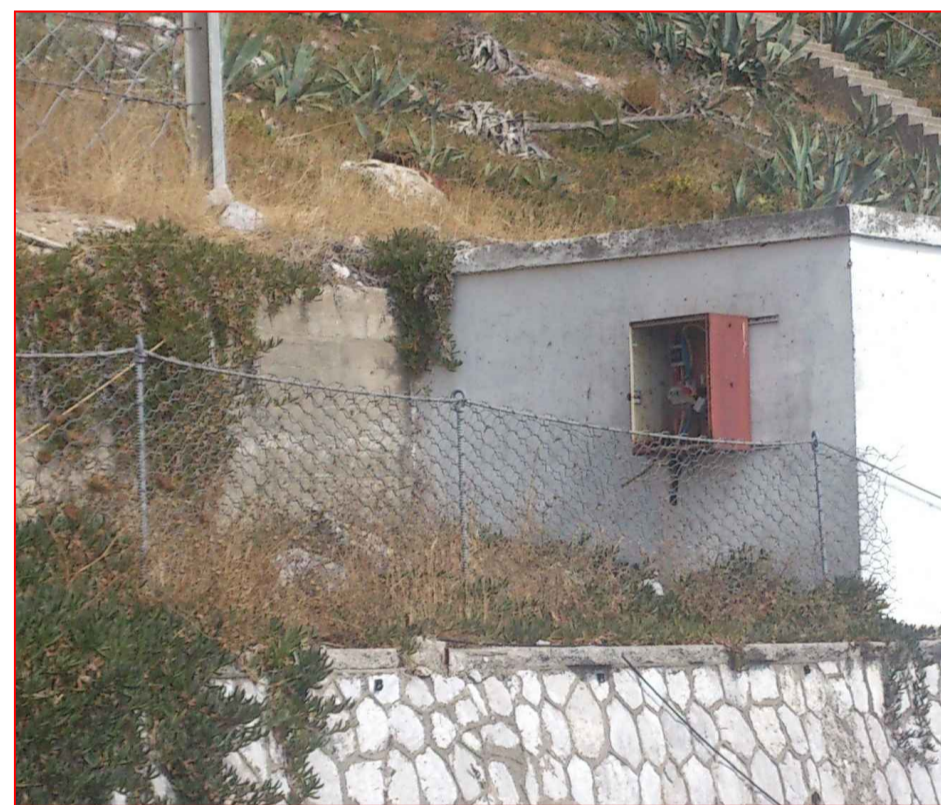

SECTION E-E PHOTOS



SECTION D-D PHOTOS



SECTION B-B

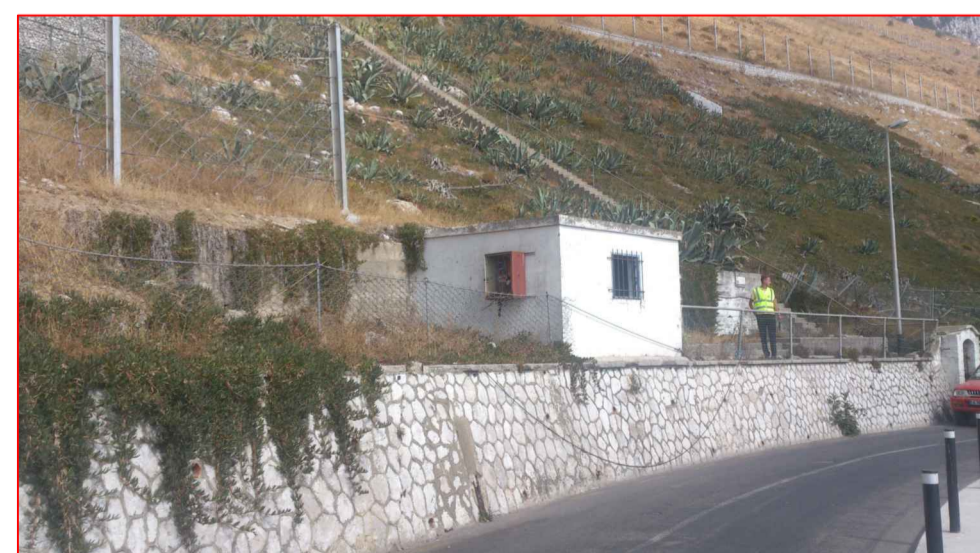

VIEWPOINT 3

SECTION A-A ELEVATION

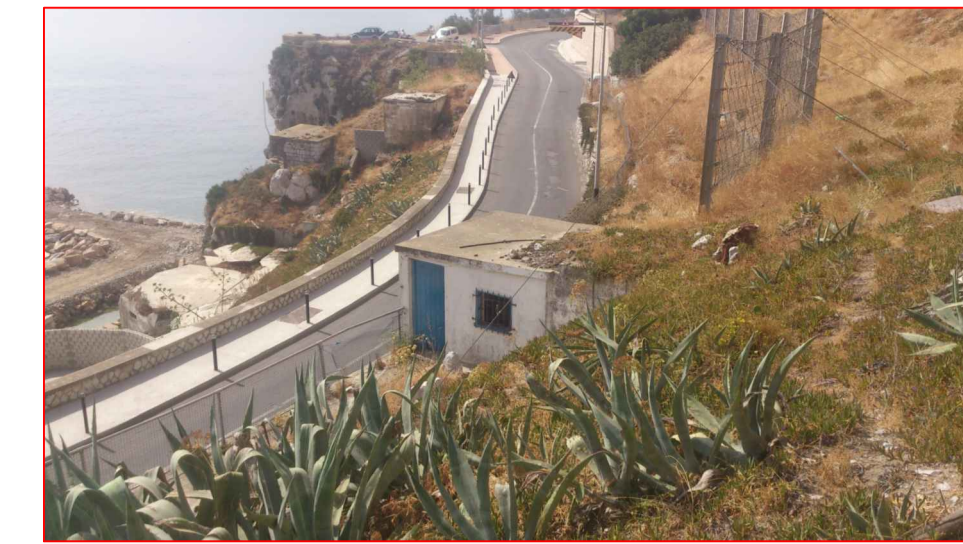
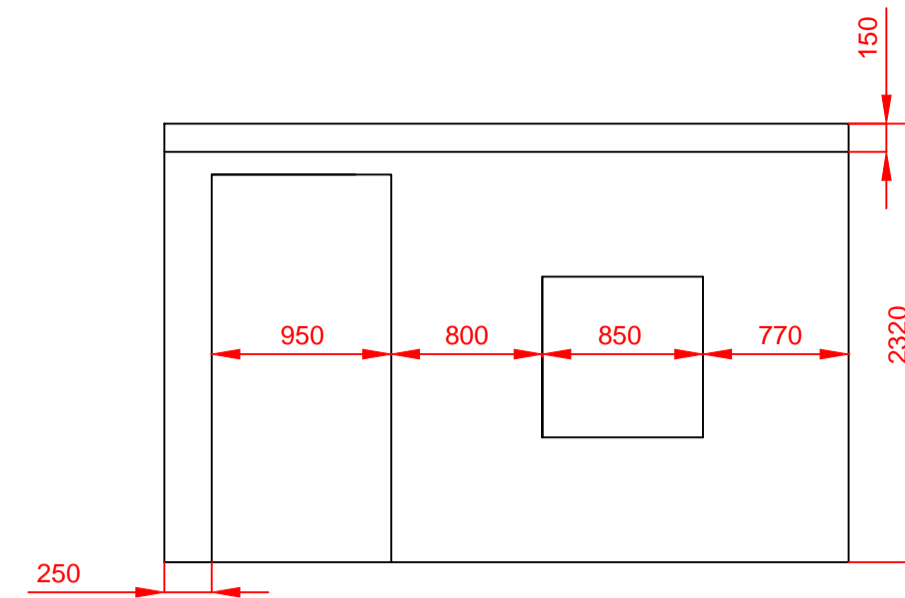

VIEWPOINT 1

SECTION A-A PHOTOS



VIEWPOINT 2

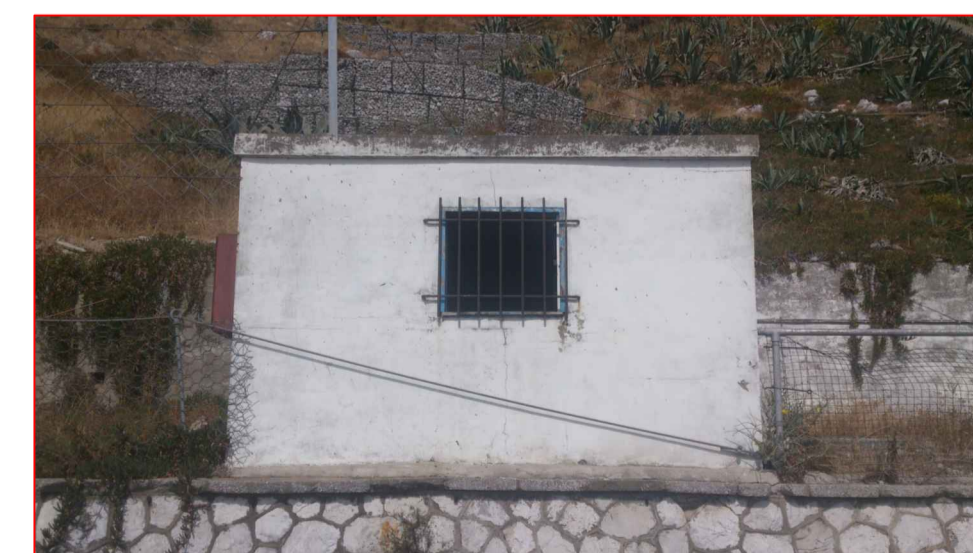
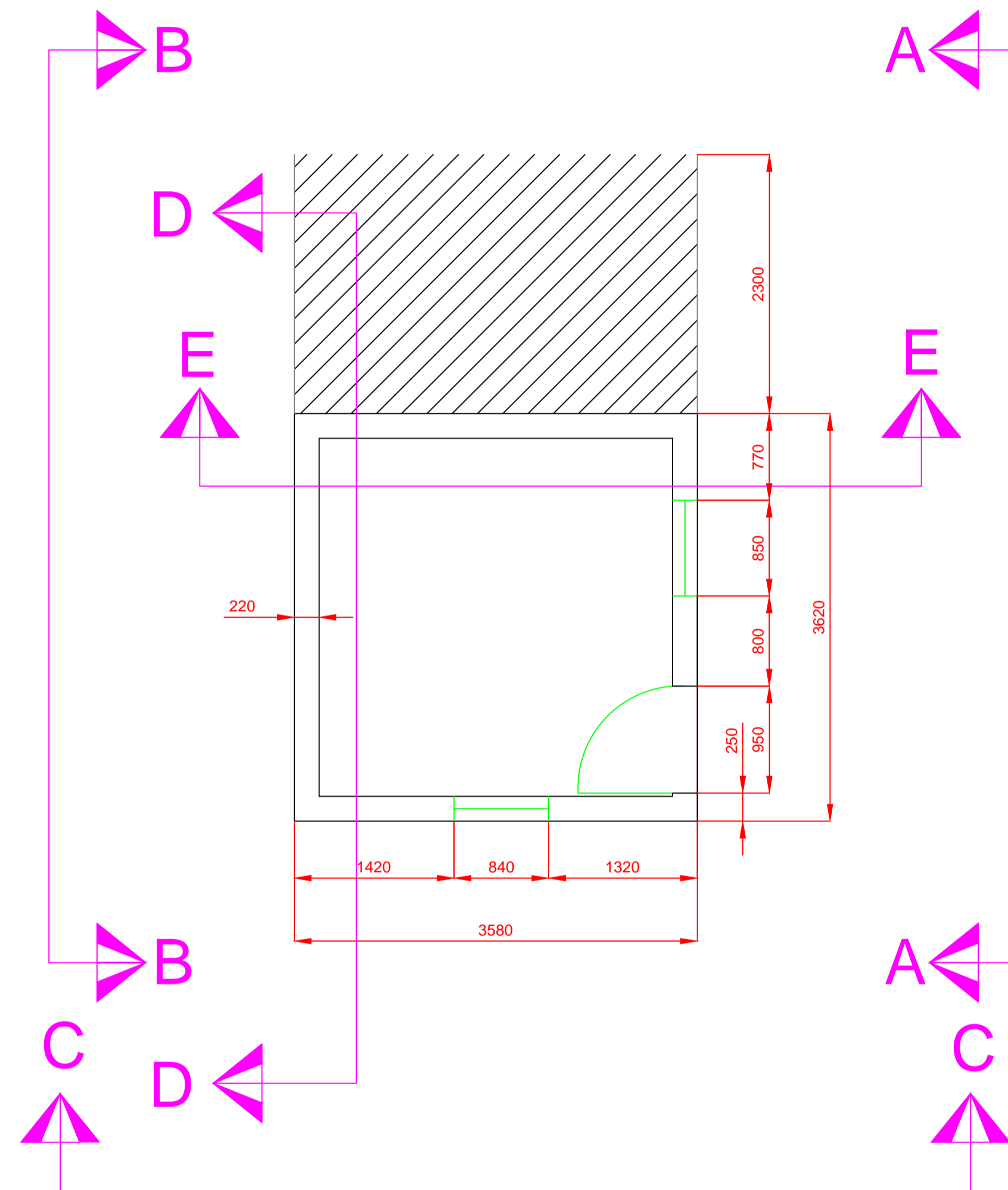

SECTION C-C

PROPOSED DEMOLITION PLAN

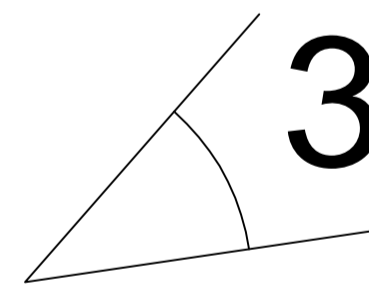
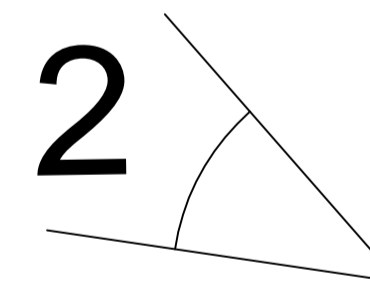
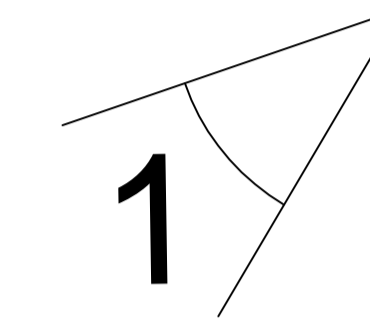

NOTES:

- 150mm concrete roof slab with corrugated steel sheeting
- 220mm thick masonry wall
- General structure height 2320mm

GENERAL DEMOLITION NOTES:

- 1) THE DEMOLITION IS TO BE CARRIED OUT IN SUCH A MANNER SO AS TO CAUSE AS LITTLE DUST, NOISE AND INCONVENIENCE TO THE GENERAL PUBLIC.
- 2) THE CONTRACTOR HAS TO OBTAIN APPROVAL FROM THE NECESSARY STATUTORY AUTHORITIES PRIOR TO STARTING THE DEMOLITION WORKS ON SITE.
- 3) CONTRACTOR TO ENSURE THAT THE NECESSARY DISCONNECTION CERTIFICATES HAVE BEEN OBTAINED.
- 4) CONTRACTOR TO INSPECT DRAINS AND SERVICES AND PROTECT AS NECESSARY.
- 5) CONTRACTOR TO AGREE EXTENT AND POSITION OF THE HOARDING WITH THE GOVERNMENT SUPERVISING OFFICER.
- 6) ALL ASBESTOS WITHIN THE SITE TO BE REMOVED IN ACCORDANCE WITH THE APPROVED METHOD STATEMENT PRIOR TO COMMENCING THE DEMOLITION WORKS.
- 7) THE DEMOLITION IS TO BE CARRIED OUT IN ACCORDANCE WITH THE APPROVED METHOD STATEMENT.
- 8) GROUND SLABS TO BE BROKEN DOWN AND FOUNDATION TO BE REMOVED, UNLESS NOTED OTHERWISE BY GOVERNMENT SUPERVISING OFFICER.
- 9) CONTRACTOR IS TO ENSURE HE IS CONVERSANT WITH THE PRE-TENDER HEALTH AND SAFETY PLAN AND HAS SUBMITTED THE NECESSARY RISK ASSESSMENTS AND METHOD STATEMENTS.
- 10) WHERE VOIDS ARE TO BE FILLED WITH SELECTED DEMOLITION MATERIAL, THIS SHOULD BE CARRIED OUT IN LAYERS NOT EXCEEDING 200mm.
- 11) THE CONTRACTOR IS TO TAKE SPECIAL CARE IN PROTECTING EXISTING EXTERNAL PAVED AREAS.
- 12) DEBRIS IS TO BE DISPOSED OF FROM SITE TO AN APPROVED LOCATION.
- 13) STEEL FRAME TO BE DISMANTLED AND DISPOSED OF, AS INSTRUCTED BY GOVERNMENT SUPERVISING OFFICER.
- 14) ALL DIMENSIONS MUST BE CHECKED ON SITE AND NOT SCALED FROM THIS DRAWING.
- 15) THIS DRAWING MUST BE READ IN CONJUNCTION WITH DRAWING No. 61 / 330

A	Date	Revision



Client

Job Title
Demolition of existing security post (Both Worlds)

DRAWING TITLE
DEMOLITION PLAN

Scale 1:40

Date 15.07.2013 Drawn by D. INFANTE

Drg. No. 60/129 Rev.